

Technical Spec

VIDEOLOGY

THE FILM STUDIO

- Size: 36m² (6m x 6m)
- Ceiling height: 3m
- Lights installed on the ceiling rail and controllable via the DMX console
- Matte black walls
- Live production control room with direct view to the filming studio

THE ADDED VALUE

- Spacious lounge area for up to 20 persons with live image from the studio
- Makeup room with a shower
- Nespresso coffee all day and complimentary French pastries in the morning
- A working station with Adobe CC at your disposal
- Direct car access in front of the studio for easy loading
- 2 optic fiber internet for live streaming
- Air conditioned

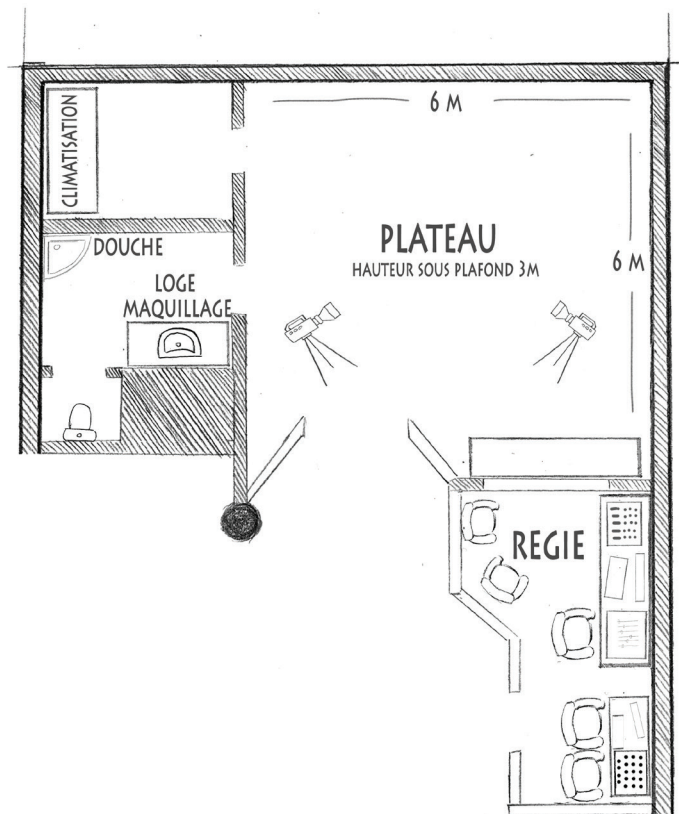

THE CYC WALLS

	Color	Floor covered	Width (m)	Depth (m)
3-side cyc wall (back & 2 lateral sides)	Green, Black	No	5m	1.5m
2-side paper backdrop (back & floor)	Green, White	Yes	2.8m	-

THE LIGHTS AND ACCESSORIES

We provide the majority of commonly used lights and accessories. Most of the essential lights are already installed on the ceiling rail and can be controlled by the DMX console.

What's included	Quantity	On the rail
Cineroid ML800	7	Yes
Practilite 604	2	Yes
Kino 2/60	6	Yes
Kino 2/120	2	Yes
Cosmolight 2/60	5	
Cosmolight 4/60	2	Yes
Mizard 300W	2	Yes
Mizard 500W	3	Yes
Manda	2	
Diffusion frame 1x1	1	
Diffusion frame 120	1	
Flag	2	
Clamp	10	
Grip head	4	
Extension arm	2	
Light stand	8	
Autopole	4	
DMX lighting console	1	
Ballast	2	

Additional	Quantity
Cineroid ML800 Chimera with Grid	2
Aputure LS COB 300X + Light Dome II	2
Ring light	1
Sunstrip T10	2
Intellytech Light Cannon X-100	3
Kino 4/120	2
PAR 64	2
PAR 16	10
Digital Sputnik Tube Led Voyager 120	2
Godox LED RGB SZ140R	2

A WIDE RANGE OF EQUIPMENT FOR HIRE

Just bring yourself, we've got you covered. We offer various packages according to your needs: studio rental only, studio rental with furnishing, all-inclusive filming package or customized plans with a large choice of equipment to suite your needs.

THE LIVE PRODUCTION AND STREAMING

We have a fully equipped control room with live production and streaming capability for hire . The control room has a direct view and talk back system to the filming studio.

- Fully equipped for live production and streaming
- 2 optical fiber internet connections for stable HD live streaming
- Direct view to the filming studio

What's included
Tricaster Tricaster TC2 Elite + Newtek 2 Stripe Panel
Tricaster 455 + Panel 460 CS
HyperDeck Studio Pro
Smart Videohub 12x12 Cleanswitch router
Teradek Cube encoder
Intercom HF Hollyland Mars T1000
Berhinger X32 Producer & X32 Compact console
Atomos Sumo 19" recorder + Shogun Studio 2
32" Multiview Monitor x 3 + 42" PGM Monitor
MIMO Live duplex station + telephone dial-in